



# ARBOR

BESPOKE CABINET MAKERS LTD.

2024







*“Thoughtfully designed  
expertly crafted”*



## CONTENTS

- 4. INTRODUCTION
- 7. BESPOKE DEFINED
- 8. WORKSHOP
- 10. PROCESS
- 12. THE BLAKE COLLECTION
- 14. THE MEAD COLLECTION
- 16. RLD STUDIO
- 18. CONTACT

Arbor Bespoke Cabinet Makers draws inspiration from the rich heritage of Great British design to create luxury furniture that is timeless and unique.





## INTRODUCTION

Arbor Bespoke Cabinet Makers is located in the beautiful Pewsey Vale of Wiltshire. Drawing inspiration from the rich heritage of British craftsmanship, Arbor is an established supplier of meticulously crafted fitted and freestanding furniture that balances functionality and elegance.

Whilst renowned for our exceptional kitchens, our design knowledge extends far beyond. We are ambitious and passionate, collaborating with our experienced team of makers, we take pride in delivering completely bespoke fitted furniture and free-standing pieces.

Arbor is owned by Richard and Tina Lansley.

Richard is meticulous in his design with a long career of running his own high end residential design consultancy and Tina is practical and client focused after a long career in hospitality and management.







## BESPOKE DEFINED

Bespoke is a popular term, at Arbor this means custom, made to measure and designed for you.

We love working with interior designers and home owners, bringing dreams to life. We're here to guide you through process, to have open discussions, and answer all questions.

We work with a range of timbers, veneers and man-made products to ensure durability, elegance and ease of use. These are all chosen based on what works best for what you are looking to achieve.

The materials we use to make, the hinges on our doors, our drawer runners and hardware are all carefully chosen to work with the design, whilst offering strength and endurance.

Working through all of the details of your project at the outset can be overwhelming. Our estimates usually start using one of our collections to help visualise your project, a plan of the space and a guide to costs.

If you would like to proceed from here, we work with you to design your space exactly how you would like it to be . We don't have set sizes, hold stock or limit colour choice , every item is designed and crafted exactly for you.





## Workshop

The heart of Arbor lies in the hands of our skilled joiners.

Our approach relies on our extensive experience and traditional craftsmanship, to bring our bespoke designs to life.

We have a solid timber mill shop where the hardwoods such as tulip wood, oak and walnut are prepared. We also have a sheet shop where the man-made boards are cut to shape.



Pieces are assembled by hand, with great care and time taken over the construction. We use traditional jointing methods such as mortise and tenon and dovetail joints, along with the more modern domino and biscuit system for strength and longevity.

Our makers take pride in passing along skills and traditions to the next generation.

Our work graces a range of properties from rural estates and cottages to city apartments.





## Process

We arrange a convenient time to meet to discuss your project and get to know what you are looking to achieve. We're always ready to take a brief survey of the space, or go through architects plans with a scale rule. After this we can produce an initial proposal, plan and sketch.

Next is the detailed design process. During this stage we will meet several times, and produce detailed CAD drawings, sketches and visuals. We'll go through appliances and make a schedule. It's really important that all of the details are understood and incorporated at this stage. We sometimes make prototypes and always offer samples at this stage to make sure everything is as you planned it to be.

We'll survey site before we start the production drawings. At this point the design is finalised and signed off.

We then move to in production. We hand craft all of the furniture, assemble and then take apart for finishing. There's always sanding to ensure a good finish. Priming and painting, or veneering and lacquering, will depend on materials and final design.

Our skilled installers ensure accuracy and customer satisfaction. Most of our fitted furniture is built with scribe panels to make sure the fit on site is perfect. If we are supplying stone worktops, these are always templated for at site to make sure everything is completely accurate before fitting. Knobs and handles are always fitted last to ensure the positioning is just right. We then schedule an aftercare visit 3 months after you've moved in to make sure everything is as planned.







# THE **BLAKE** COLLECTION

This collection is more contemporary and offers greater flexibility within a range of design concepts. The collection is named after Martin Blake, who took on the business after John Mead in 2006.

The Blake Collection is an overlay door style, meaning the doors sit in front of the cabinets with end panels fitted to the carcass to create a seamless modern look.

The interior is made from a melamine faced MDF which is durable with the option to specify a real wood veneer, should you prefer.

Concealed hinges offer greater flexibility. Hidden from view with features such as wide opening angles and soft close for improved functionality.

Greater adjustability means The Blake Collection cabinets can be manufactured more efficiently.





## *The* MEAD *Collection*

Heritage inspired furniture with a timeless approach to cabinetry, named after John Mead, who founded the original business in 1968.

The Mead Collection is based on an in-frame design, delivering a traditional furniture style.

The cabinet doors and drawers are set within a cock beaded hardwood frame.

The oak veneered interior and solid oak lipping brings a feeling of luxury and fine finish to your cabinets.

Hinges and hardware can be specified in many different styles and finishes to your choosing. Arbor's go to hinge is an unlacquered brass butt hinge to allow it to develop a beautiful patina finish.

The makers take time to ensure each door perfectly fits its place as every door is unique and matched with it's own frame.







RLD Studio

RLD studio is our design only service. Your project might not be built yet and you're looking to resolve the design before breaking ground, or you're looking to resolve the technical drawings and design before going to tender to different contractors.

In 2004 Richard established Richard Lansley Designs Ltd, which is now RLD Studio. Initially created to allow interior designers to focus on the overall design aesthetic, Richard would support with technical expertise and detailed AutoCAD drawings.

His diligence and knowledge of traditional appropriate detailing is second to none.

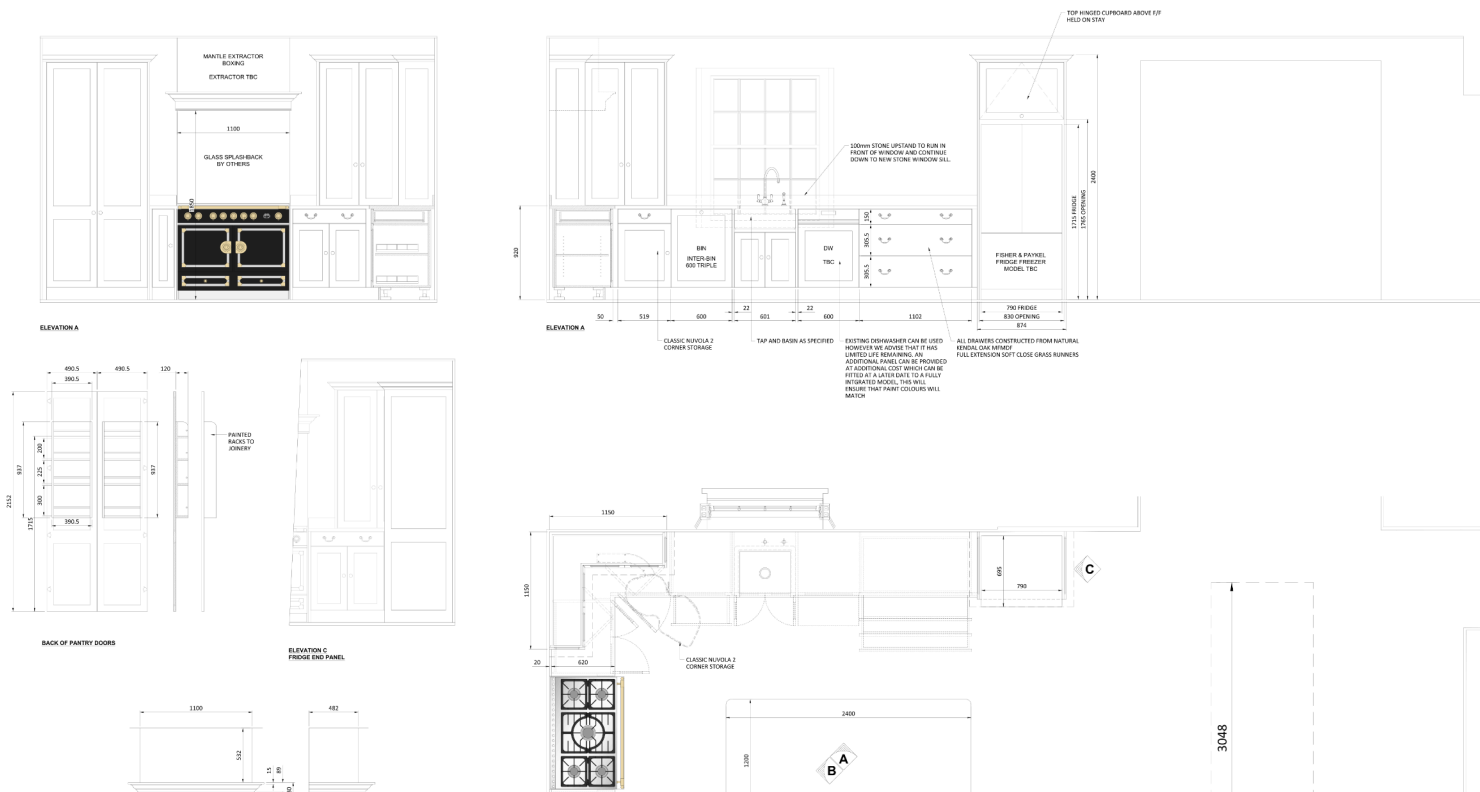

Richard has always been interested in design and problem solving. He studied Furniture and Related Product Design BA (Hons) at Buckinghamshire College, graduating in 1998.

Taking a brief sabbatical from running his own business to head up the design department for Artichoke Kitchens in Somerset inspired Richard to take on his own established furniture manufacturing business.

Always keen to learn and perfect his design Richard thoroughly enjoys the process of continually improving his designs, seeking feedback from our makers, prototyping and assessing our work to improve his designs.





ARBOR  
BESPOKE CABINET MAKERS LTD.

Arbor Bespoke Cabinet Makers Ltd

Unit 24, Salisbury Road Business Park  
Pewsey, Wiltshire  
SN9 5PZ

+44 (0)1672 562365

abcm.uk  
hello@abcm.uk

\*=Photography credit: @astridtemplier Interior designer: @levesondesign

\*\*=Photography credit: Alicia Waite Interior designer: Phiber Interiors & The Folio Group